

# Aalto University

– Where *science* and  
*art* meet *technology*  
and *business*

12 May 2014



# Three leading universities in their own fields became ***Aalto University*** in 2010

Helsinki School of Economics (HSE)

University of Art and Design Helsinki (TaiK)

Helsinki University of Technology (TKK)



*The Aalto University  
community:  
80,000 alumni,  
20,000 students,  
5,000 staff members,  
350 professors*

# *Science, art, business and technology*

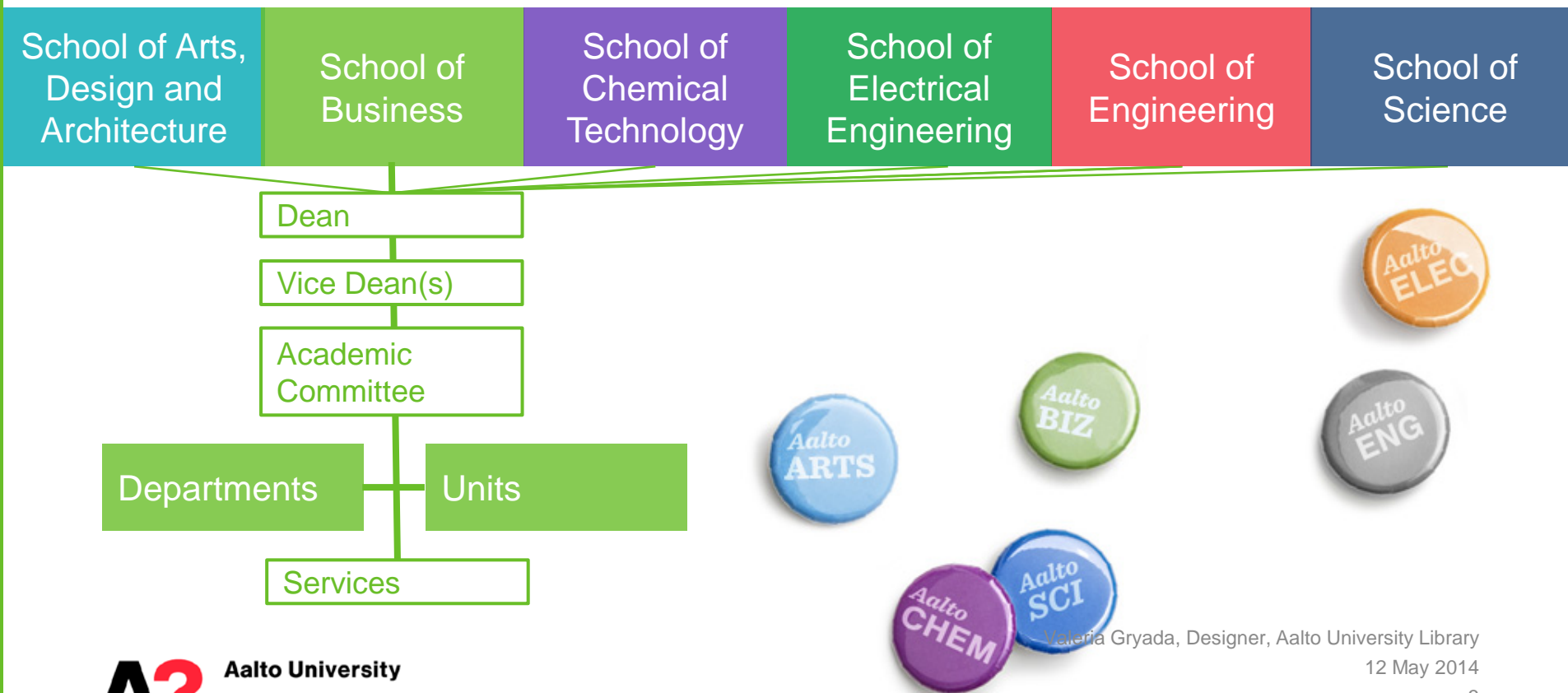

# Three libraries merged as well

# History

In 2010 three leading Finnish university libraries of their respective disciplines merged into Aalto University Library. Our library is the third-largest university library in Finland.

**A?** Aalto-yliopisto Kirjasto  
Aalto-universitetet Biblioteket  
Aalto University Library



*Otaniemi Campus  
Library:  
from 1849 as  
library of technology*



*Töölö Campus  
Library:  
from 1911  
as library of  
business and  
economics*



*Arabia Campus Library:  
from 1875 as library of arts and design*

Valeria Gryada, Designer, Aalto University Library  
2 May 2014

# Areas of strength

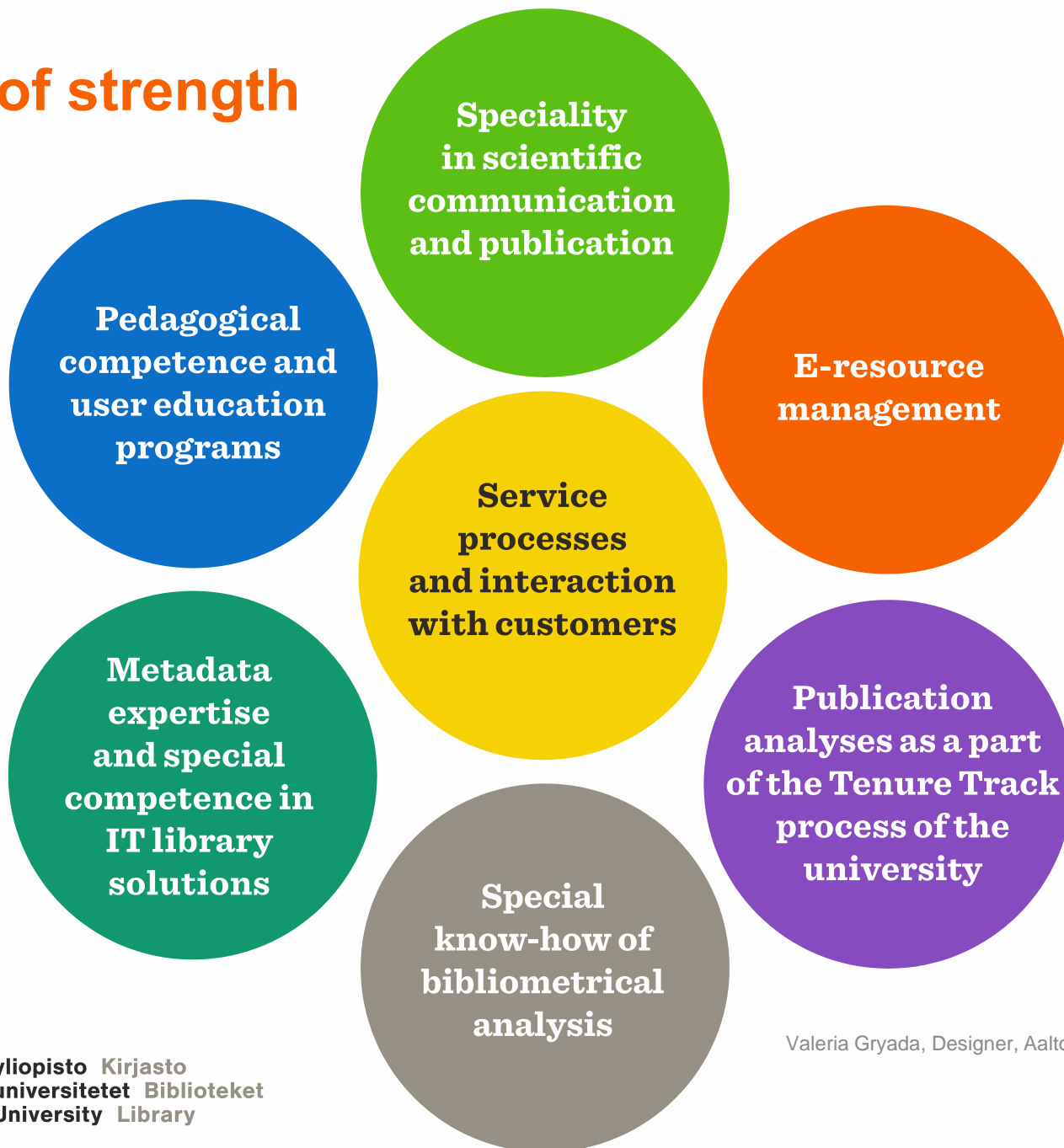



# Service and Learning environment | Customerships 2012

*458 600 visitors*

*15 700 registered active customers*

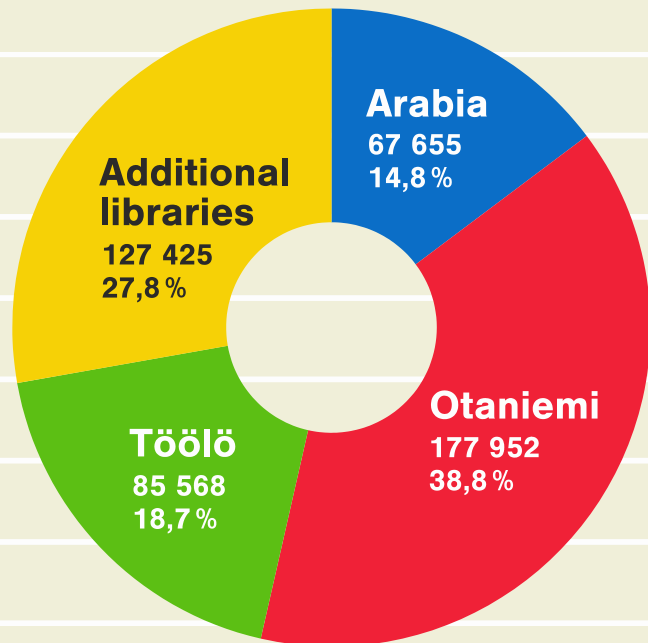

**57,9%** Aalto student

**8,0%** Aalto staff

**12,9%** Other university's student

**0,4%** Other university's staff

**6,0%** Polytechnic's student or staff

**1,9%** Other educational institution's student or staff

**1,2%** Representative of public administration

**5,9%** Representative of business life

**1,9%** Domestic Inter-library service customer

**0,1%** Foreign Inter-library service customer

**3,8%** Other

## Demand for library services | 2013

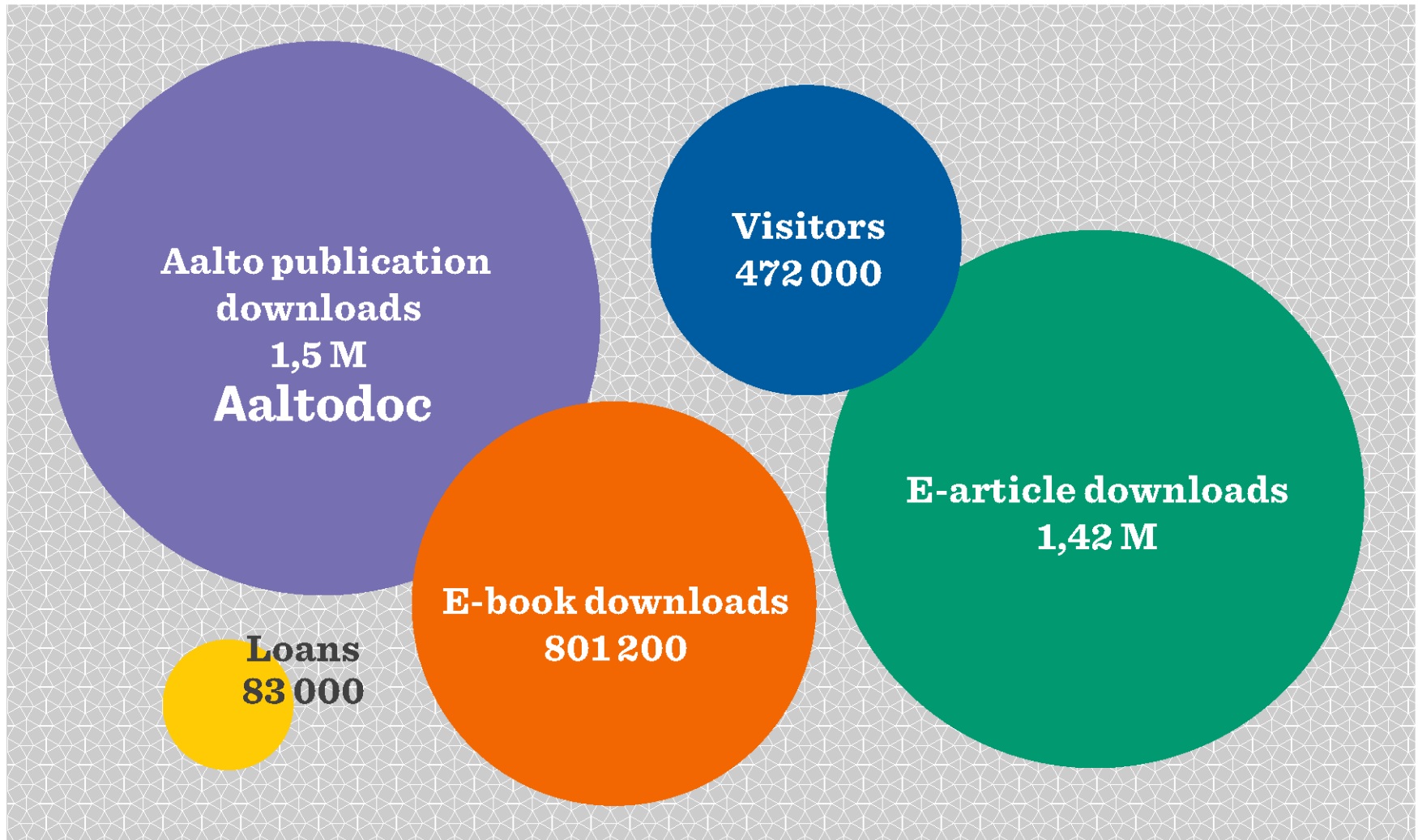

Valeria Gryada, Designer, Aalto University Library

9 February 2014





**A?**

Aalto University

# Aalto University Digital Library



Aalto University

**Library  $\leq$  Learning Center**



# Learning Center planning process: combining top-down and bottom-up.



# Learning Center Network is developed using modern product design methods

1. Lean prototyping at the **Learning Hubs**
2. New service concept for the **Aalto's Library building**
3. Beta testing with the **Learning Center beta version**

# 1. Our Learning Hub projects are energizing the Aalto University community.

*2012 - present*



Valeria Orvada Designer, Aalto University Library

12 May 2014

13



# 2.

## New service concept will change the Otaniemi campus library.



Noudattaa rutineja – tulee tuttuun tilaan lukemaan joka päivä.



Muutama ystävä kampuksella, ei tutustu uusiin ystäviin aktiivisesti.



Ottaa mielellään vastaan ohjeita tuottavuuden lisäämisestä tai tehokkaammista rutineista.



Tekee omaehtoista oppimista kaiken aikaa – ei kaipaa luentoja ja ryhmitöitä.

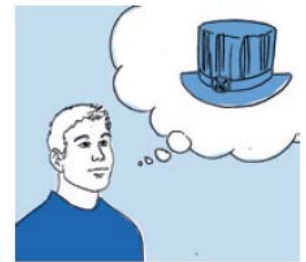

Selkeä urapolku mielessä.





Aalto University

# 3.

## Learning Center beta testing will test-drive the new service concepts.

*2015-2016*



# Learning Hub: Case “Greenhouse”

# Learning Hub Greenhouse (SCI)

**From unclaimed space to a lively co-working area in 5 months**

**Location:** *SCI, Konemiehentie 2, 02150 Espoo*

**Area:** *500 m<sup>2</sup>*

**Budget:** *15 000 €*

**Timeline:** *built during September 2012 - February 2013, running*

- Organized by a supervised student team.
- Designed based on data collected from students and staff.
- Partly built by the final users.
- Communicated through social media.
- Collaborates with other Aalto projects (Aalto Window) and outside partners (Sodexo).

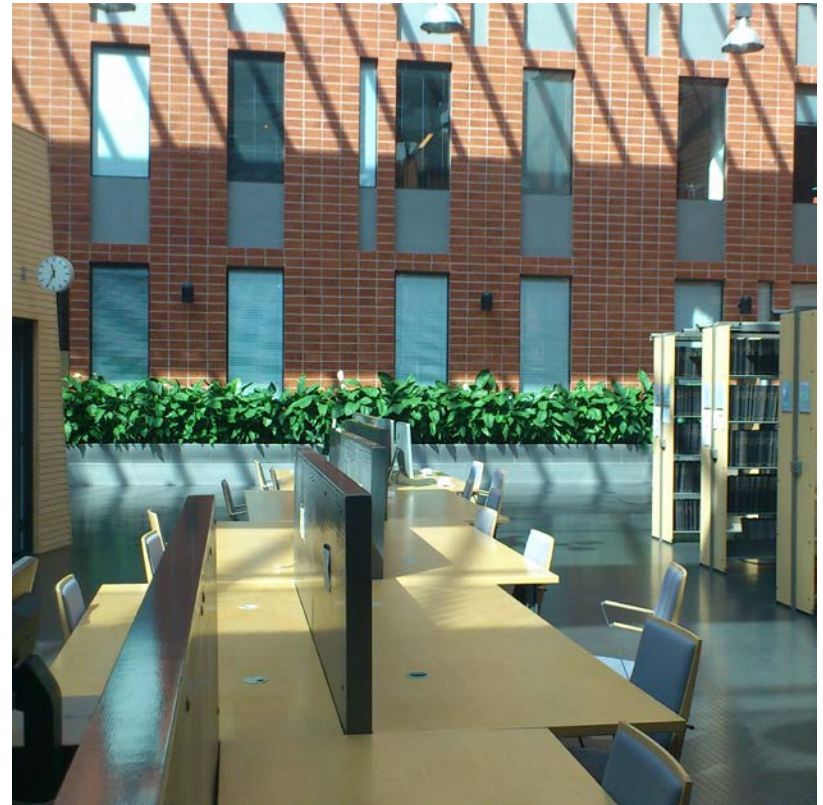

# Learning Hub Greenhouse (SCI) Development Process

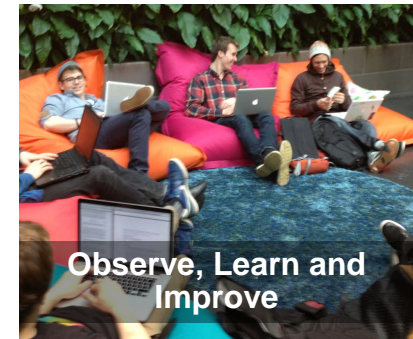
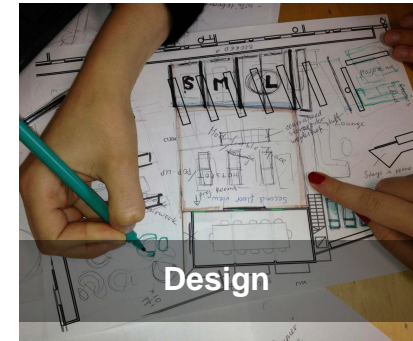
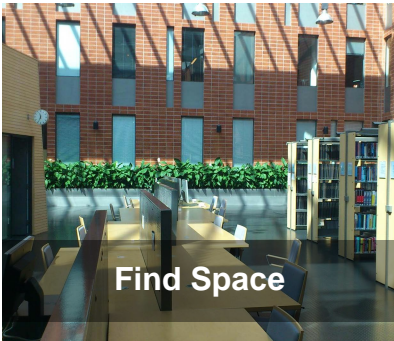

**Involving the final users at all stages is the key element to success.  
Development process is never finished.**



A high-angle photograph of the Aalto University Library's central atrium. The space is multi-level, with a ground floor featuring a large red carpeted area with colorful cushions and a wooden structure with a glass roof. A long yellow study desk with computers is on the right. Bookshelves and a purple sofa are in the background. People are seen walking and studying. A green circular graphic with the text 'Library is everywhere' is in the top right.

*Library  
is  
everywhere*



Aalto-yliopisto Kirjasto  
Aalto-universitetet Biblioteket  
Aalto University Library

Valeria Gryada, Designer, Aalto University Library

12 May 2014

19



# Learning Hub Greenhouse (SCI)

The number of visitors at the Computer Science Library has grown *more than 100%* after it was converted into a Learning Hub.

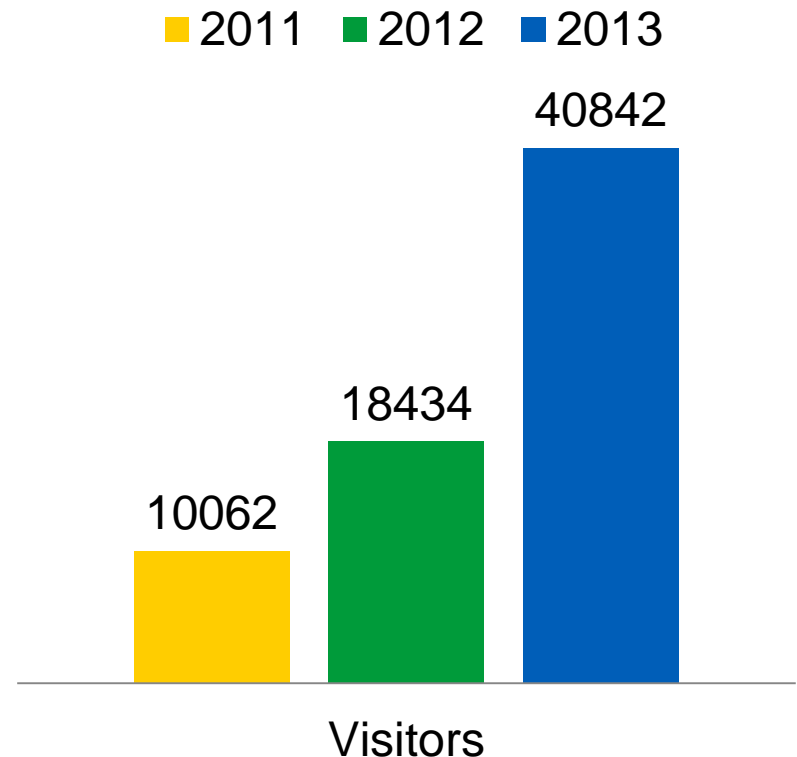





Aalto University

# Aalto University Learning Center

*Valeria Gryada*

*Designer*

*Aalto University Library*

# The Learning Center

## Milestones 2013 - 2016

Need assessment surveys, concept design, testing, project planning  
**Autumn 2013/Fall 2014**

Implementing plans **2014 - Summer 2016**

Rebuilding the Alvar Aalto Library House **2015-2016**

Evaluation and feedback **2017**

Process owners: Library and Information Services, Campus and  
Facility Services



Aalto University  
Library

Valeria Gryada, Designer, Aalto University

12 May 2017

# Old Library Spaces





# Old Library Spaces and New Learning Center Spaces



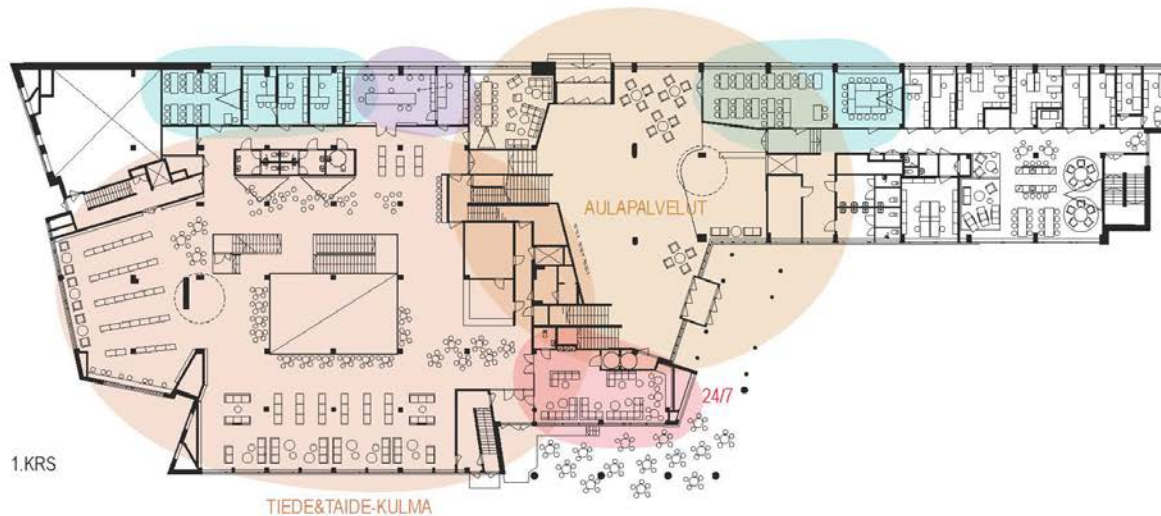

# Learning Center Network



# Together, Learning Center and Learning Hubs form the Learning Center Network

## Learning Center Network:

- offers a range of low-barrier access points to Aalto University, its services and community;
- showcases what Aalto university is;
- and provides a flexible learning environment.

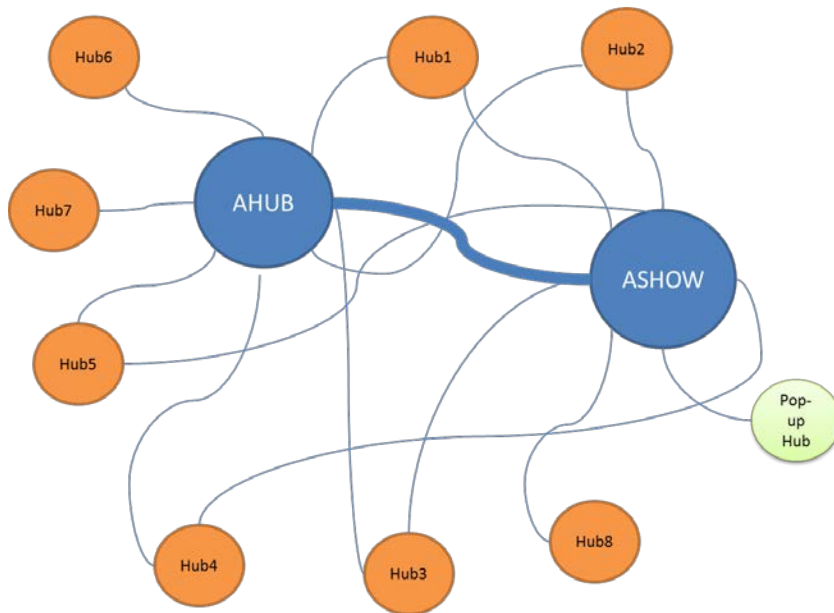

Aalto Learning Interface / Hub-thinking  
Vision from 2011

# Learning Center Network

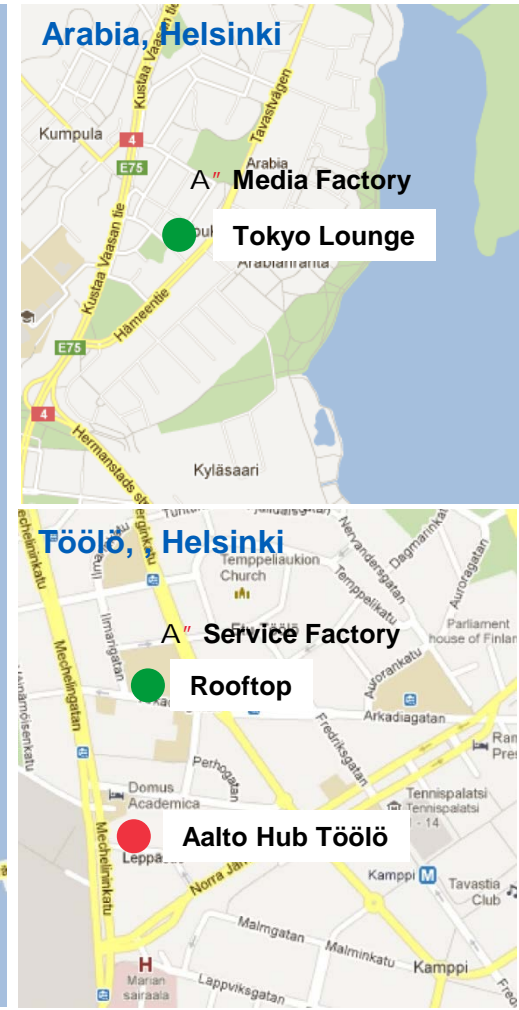

# Learning Center Network is a living organism.

4000 m<sup>2</sup>  
and growing



**Aalto University Learning Center  
is co-created with our community.**

**Learning together  
makes us best in  
the world!**