

# **The New Library of the University of Warmia and Mazury in Olsztyn**

## **Kortowo – University Campus**

**Architects – Walerian Wierzchowski and the architect team of  
the University of Warmia and Mazury in Olsztyn**

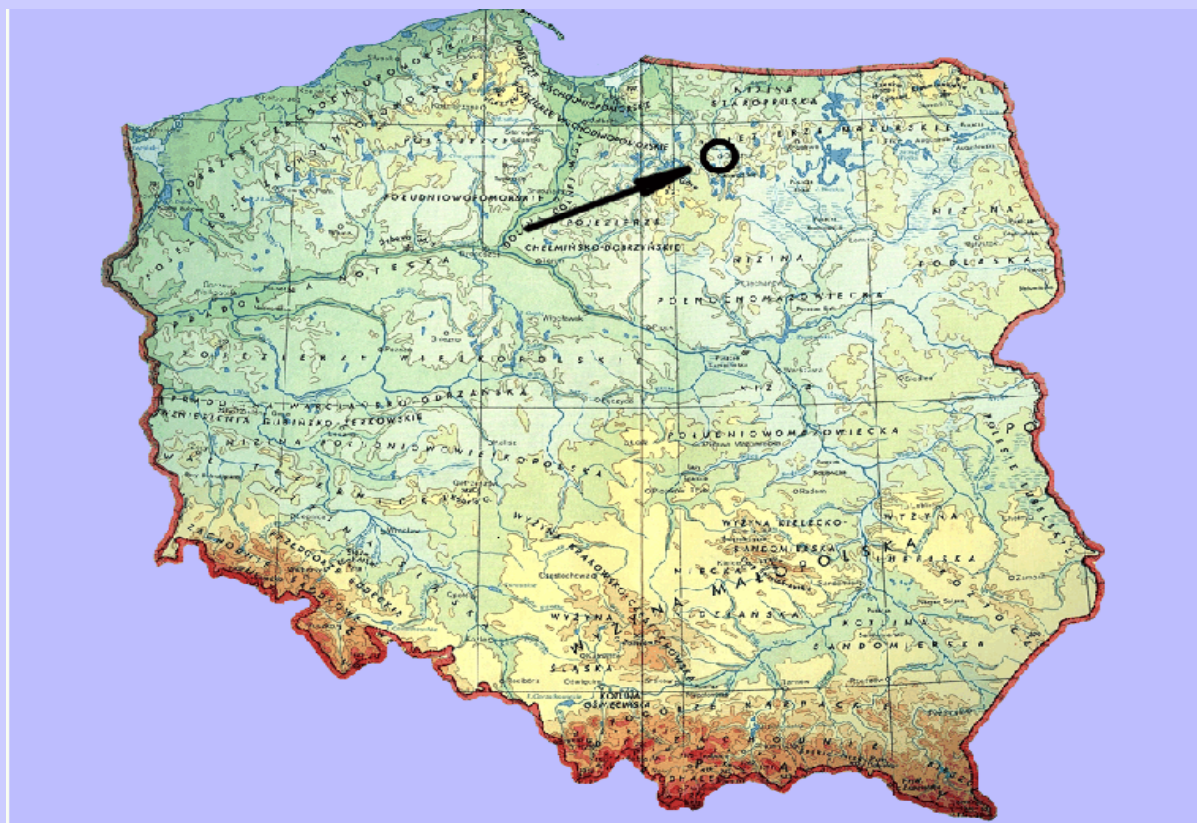

**Position of OLSZTYN on the map of POLAND**







# **Some Technical Information about the New Library Building**

- ☐ **Intelligent building management system (BMS)**
- ☐ **Air conditioning**
- ☐ **Theft detection**
- ☐ **Cameras monitoring by security staff**
- ☐ **Disabled access**
- ☐ **Security system of library holdings**
- ☐ **2 public lifts, 1 staff lift, 2 book lifts**
- ☐ **Cable channels for data connections**

# The University Library – Surface Area

<input type="checkbox"/> Total gross floor area	- 16 290 m <sup>2</sup>
<input type="checkbox"/> Open access services	- 4 818 m <sup>2</sup>
<input type="checkbox"/> Special rooms (seminar rooms, special collection, audiovisual rooms, ...)	- 1 292 m <sup>2</sup>
<input type="checkbox"/> Closed access stocks	- 1738 m <sup>2</sup>
<input type="checkbox"/> Special activites (exhibition space, lecture hall, public referesment, bookshop,museum, winter garden)	- 1 455 m <sup>2</sup>
<input type="checkbox"/> Administration and staff area	- 2 700 m <sup>2</sup>
<input type="checkbox"/> Circulation areas	- 4 700 m <sup>2</sup>

# **Schedule of the Building Process**

- ❑ Planning began in 1999**
- ❑ Project drawings by the university architect team in 2000**
- ❑ Opening of the construction work in 2001**
- ❑ Duration of the building work 2000-2007**
- ❑ Planning date of the opening of the new building – October 2007**

**SEGMENT „3”**

**for administration and staff**

- 4 levels

**SEGMENT „1”**

**for library users**

- 4 levels

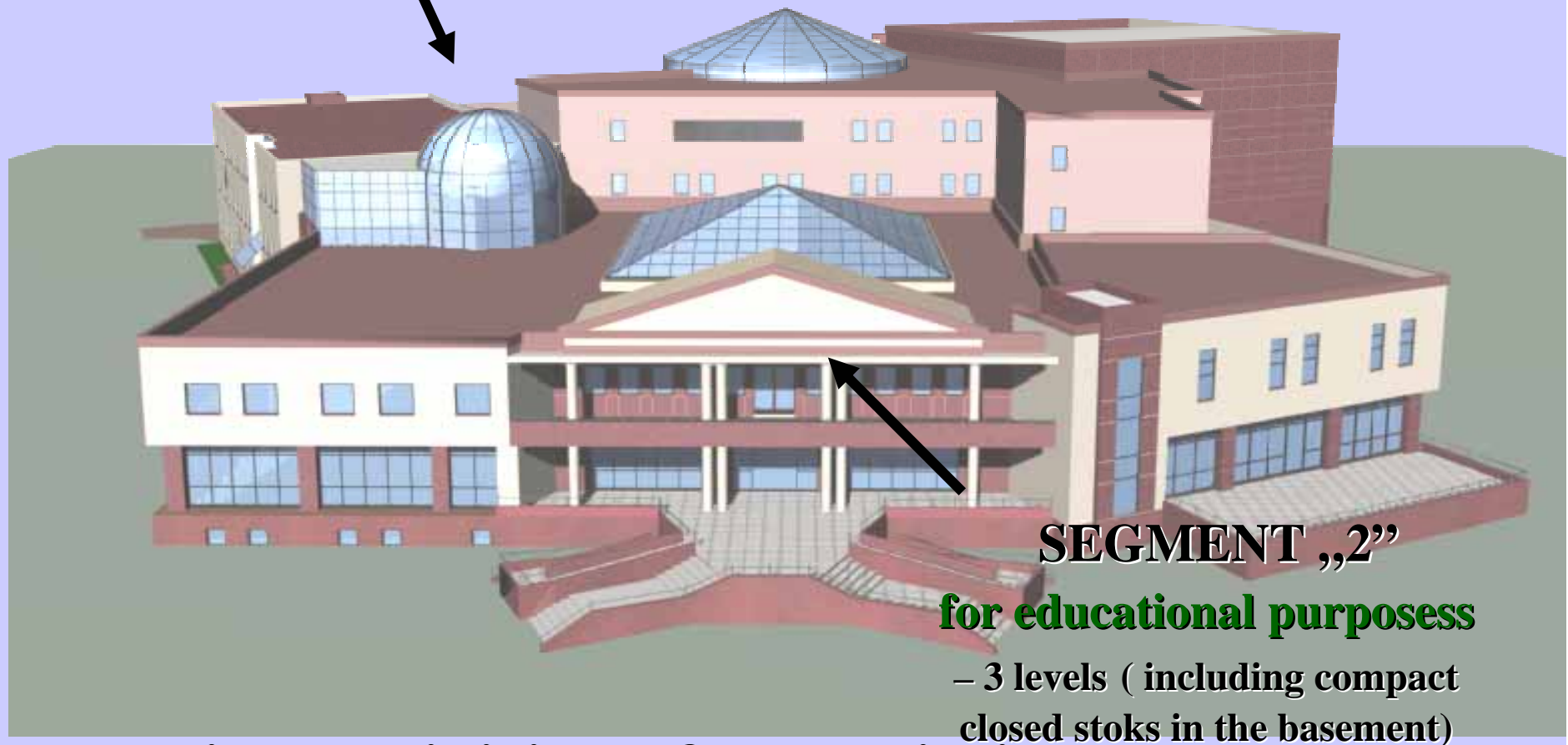

**SEGMENT „2”**

**for educational purposes**

- 3 levels ( including compact  
closed stoks in the basement)

**Functional Division of the Building**

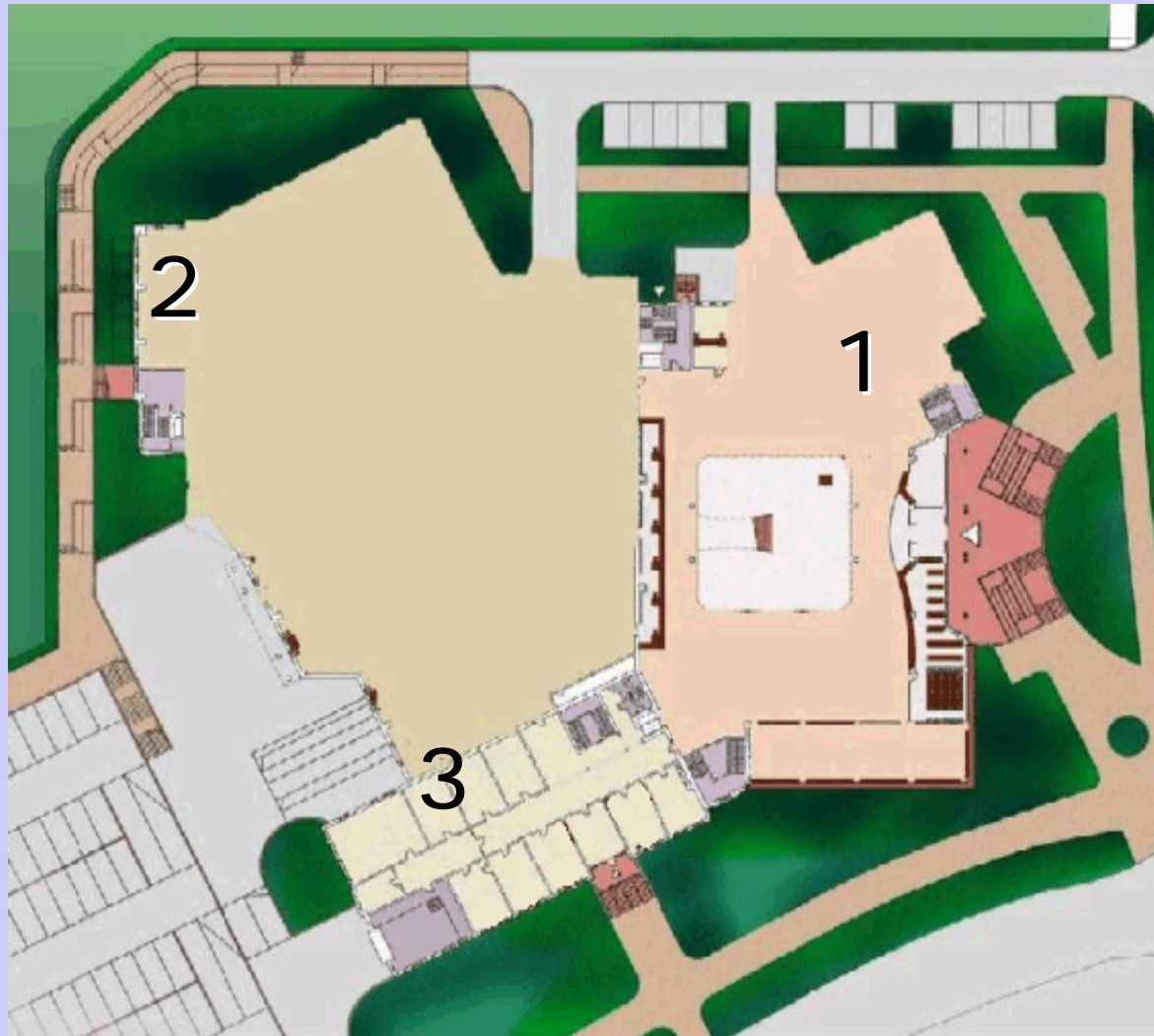

**1. Compact  
closed stacks**  
**1.738 m<sup>2</sup>**

**2. Underground  
car parking**

**3. Technical and  
storage area**

**LEVEL 0 – Basement**



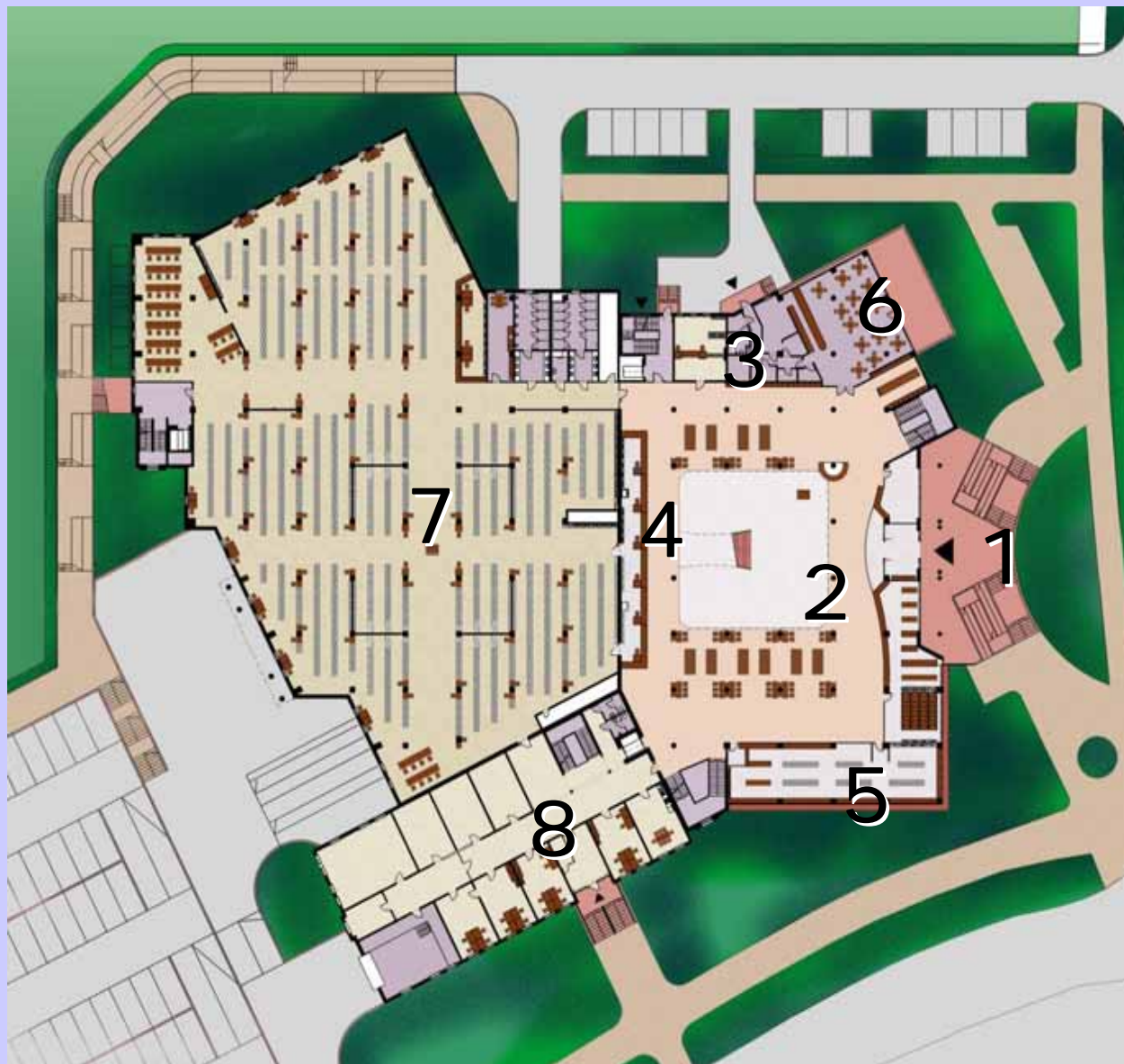

**1. Entrance**

**2. Main hall**

**- Information desk**

**- Computer catalogues**

**- 40 workstations**

**3. Interlibrary loan**

**4. Circulation desk**

**5. Bookshop**

**6. Cafeteria and  
coffee bar**

**7. Open access-  
textbook  
collections**

**- 120 reader seats**

**- 12 computer workstationa**

**8. Area for  
librarian staff**

**LEVEL I – Ground Floor**

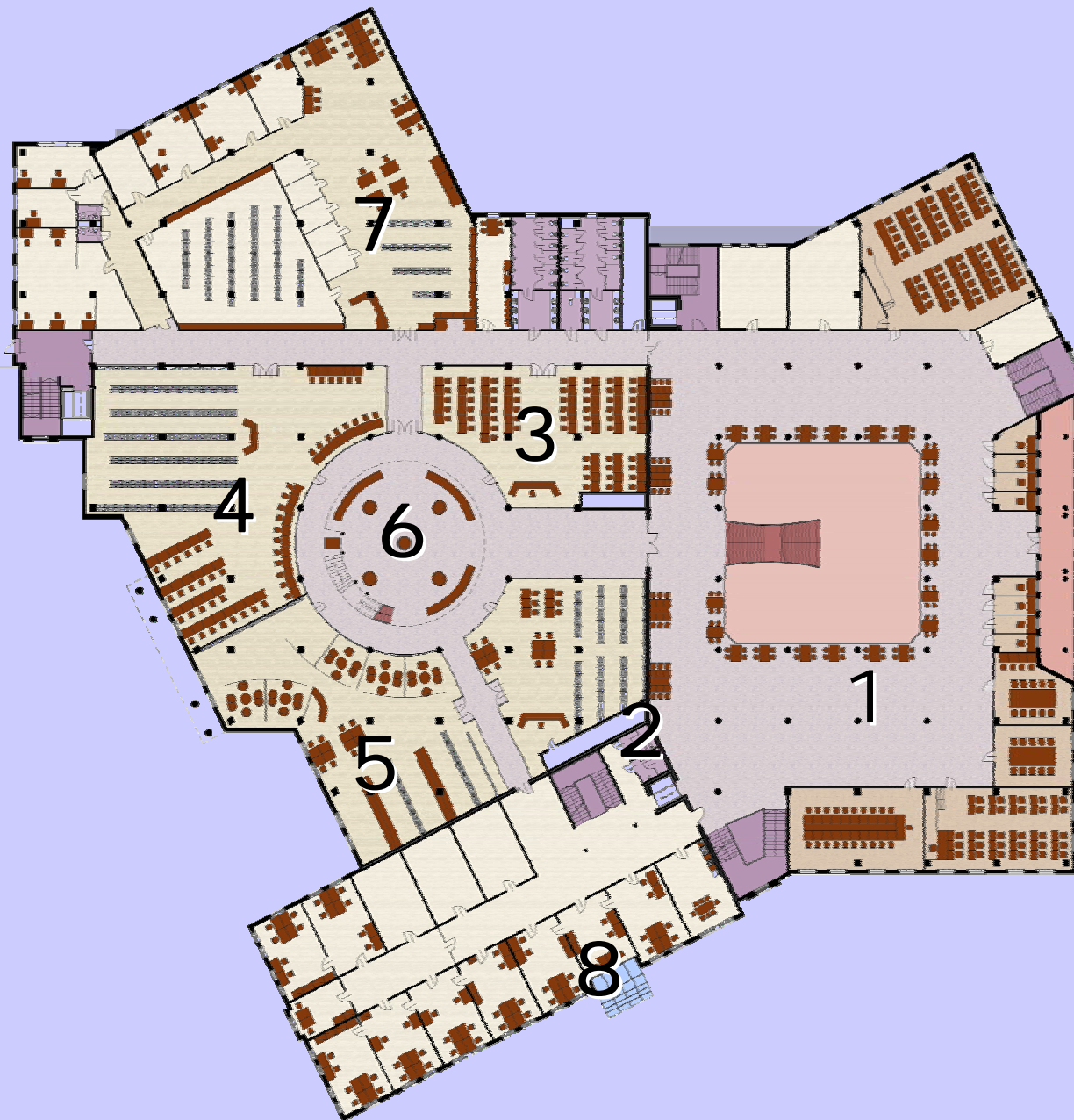

- 1.Space „Under the pyramid-shaped dome”
  - 3 seminar rooms  
( including 1 PC training room)
  - 8 booths (carrels)
  - 2 gropus study rooms
- 2.Standard and Patent Information Center
3. Computer room  
(for 60 PC seats)
4. Information division with the general reading room
5. Reading room for current periodicals
6. Space „Under cone-shaped dome”
7. Special collection area with 5 booths with audiovisual facilities
8. Area for library staff

**LEVEL II –First Floor**

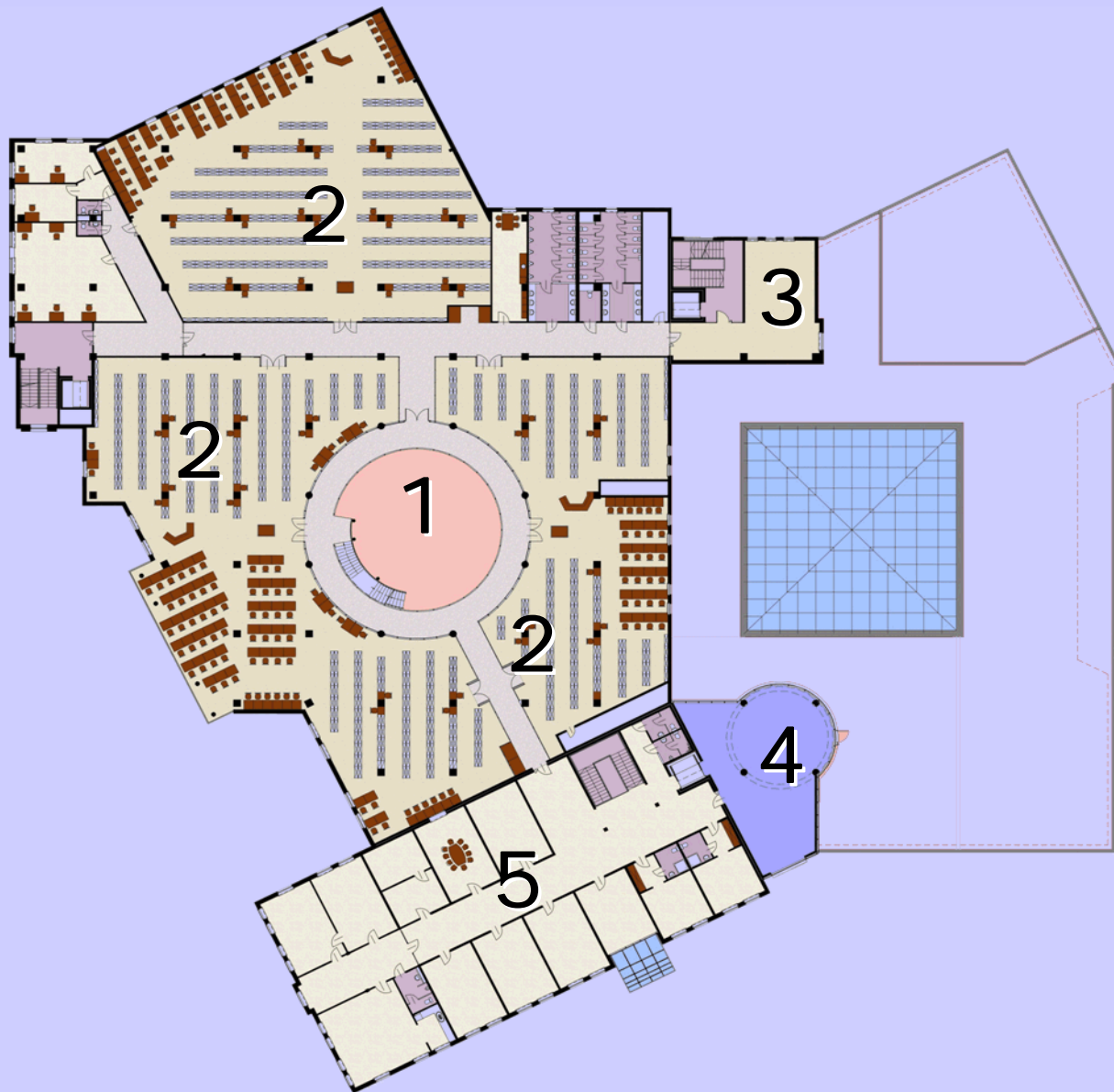

**1.Space „Under the  
cone-shaped  
dome”**

**2.Open access  
collections**

**(about 300 000 vol.)**

**- 142 reader seats**

**- 26 computer workstations**

**3. University  
Museum**

**4. Winter garden  
under cupola**

**5. Area for library  
staff**

**LEVEL III –Second Floor**



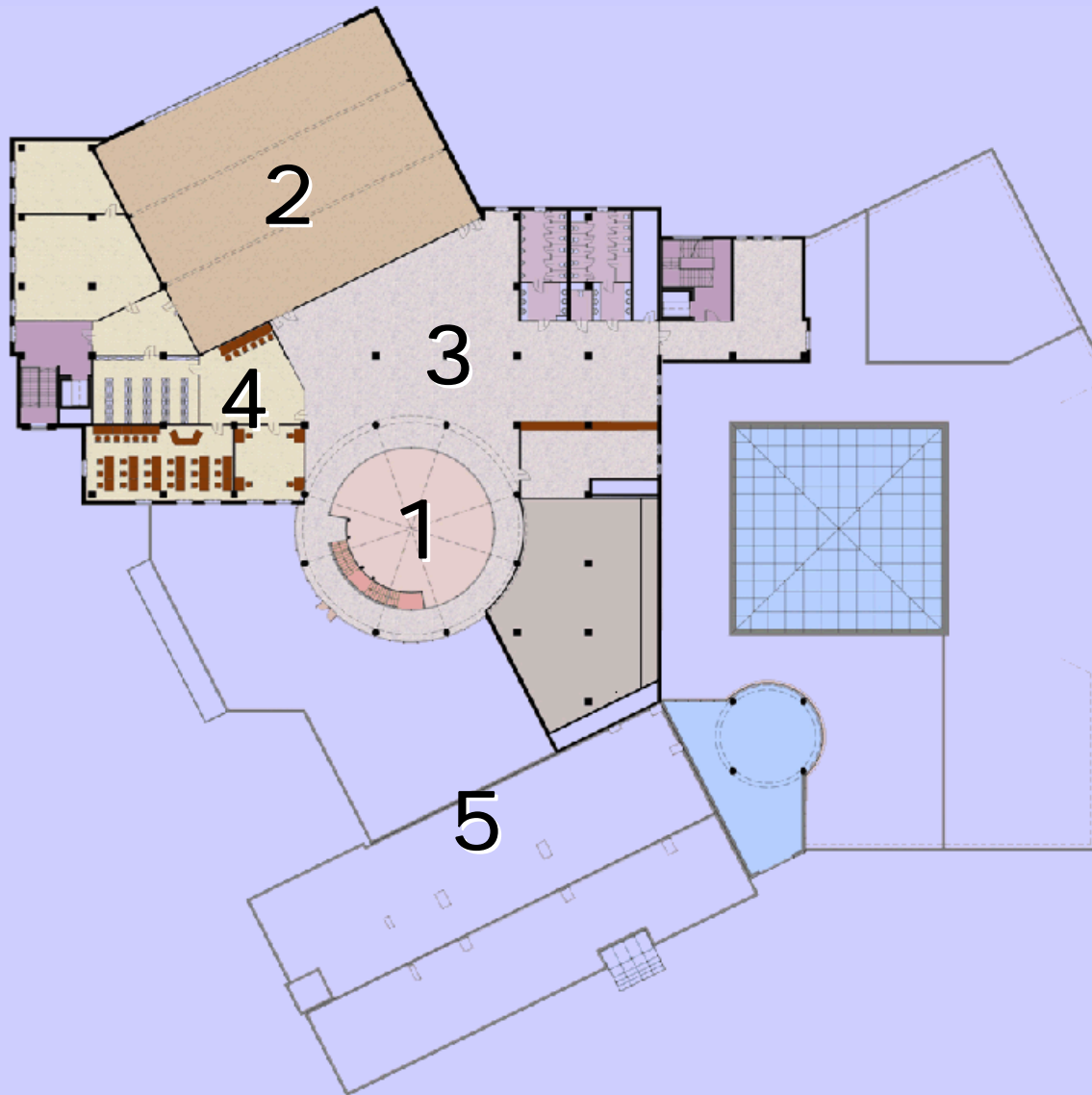

**1.Space „Under  
cone-shaped  
dome”**

**2.Lecture hall**

**– 527 m2**

**(about 350 seats)**

**3. Exhibition space**

**4. European  
Documantation  
Centre**

**5. Technical space**

**LEVEL IV –Third Floor**

# **New University Library – Number of User Seats**

- ❑ 498 regular reader seats**
- ❑ 206 PC workstations**
- ❑ 5 Audiovisual booths**
- ❑ 100 seats in seminar rooms**
- ❑ 350 seats in lecture hall**

**TOTAL - 712 USER SEATS**

**+ 100 seats in seminar room**

**+ 350 seats in lecture hall**





















