

# LIBRARY OF PARLIAMENT

Liber Architecture Group, 17th seminar

7 May 2014

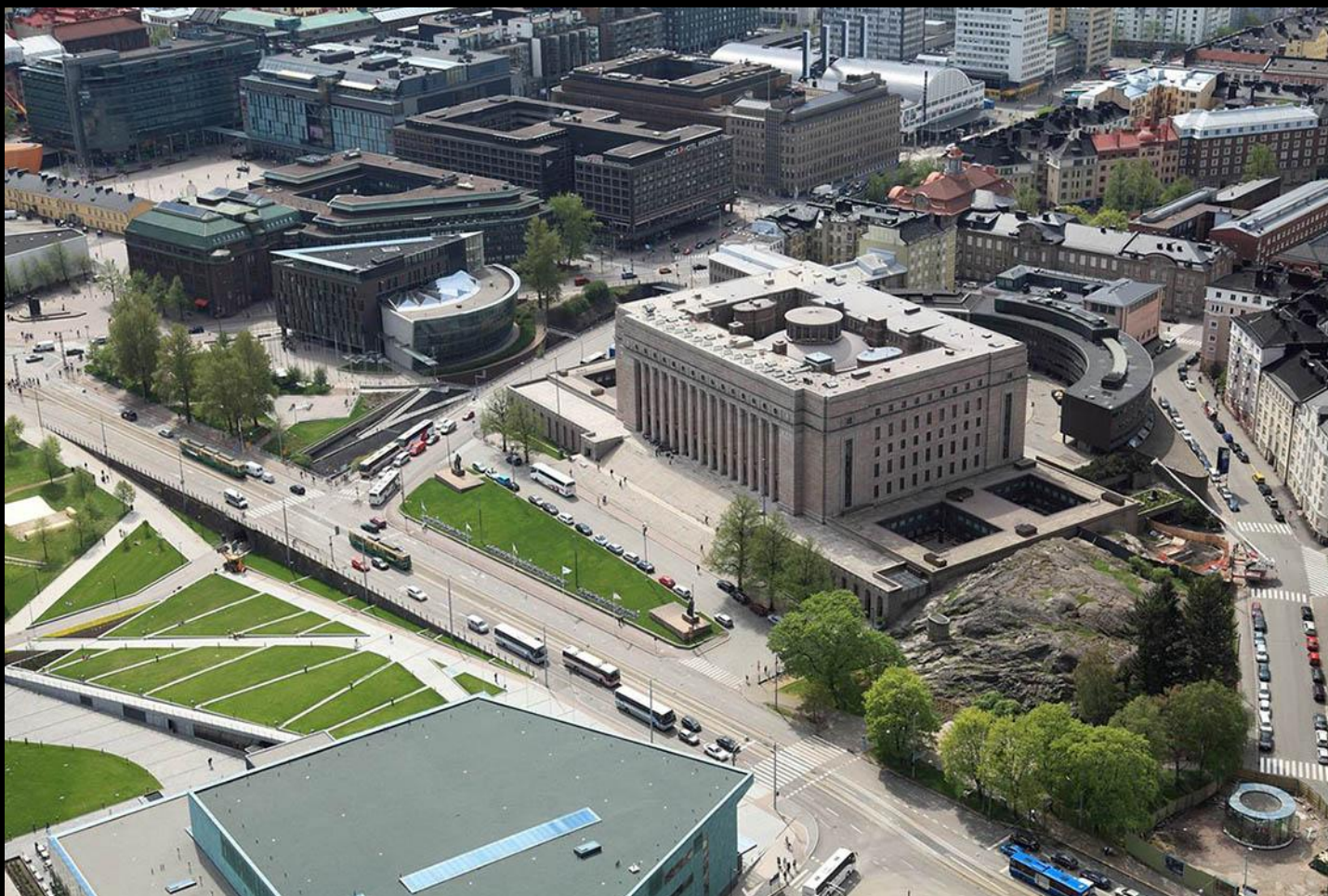









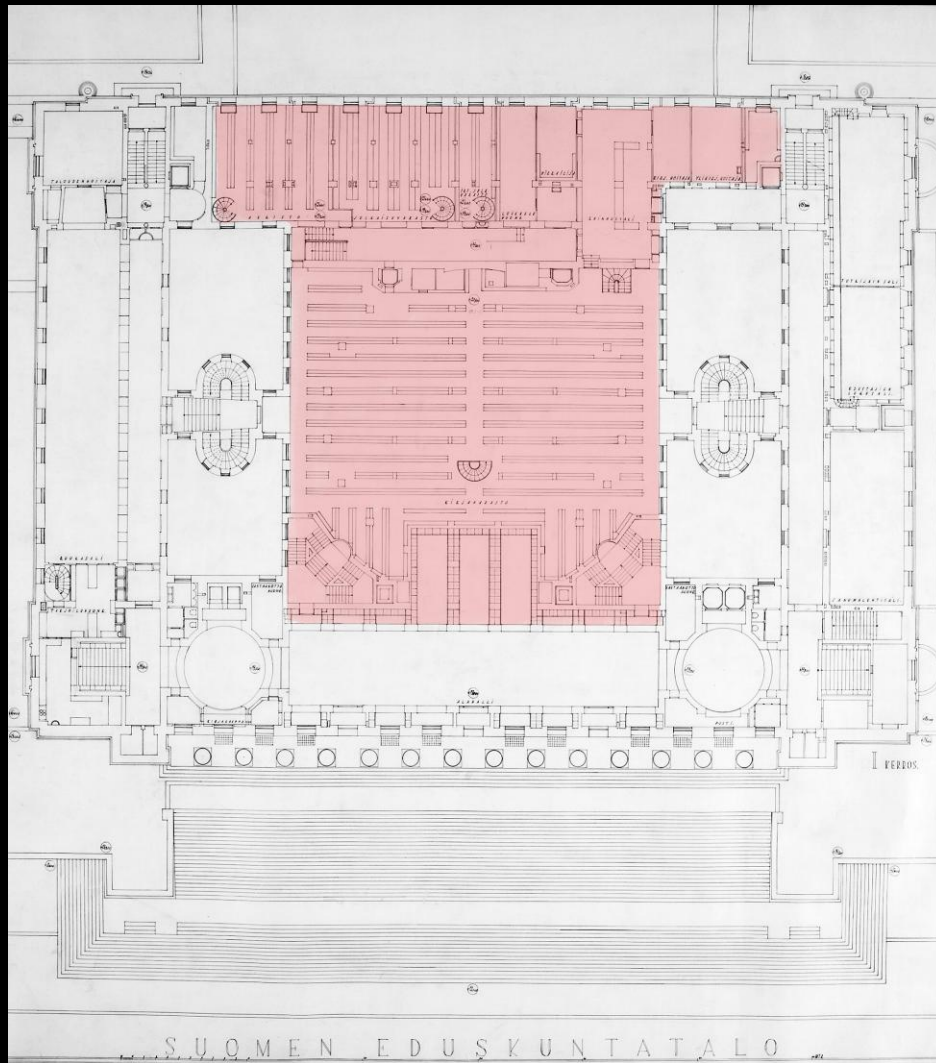

THE ORIGINAL LOCATION ON THE 1st FLOOR IN THE PARLIAMENT HOUSE - ENTRANCE

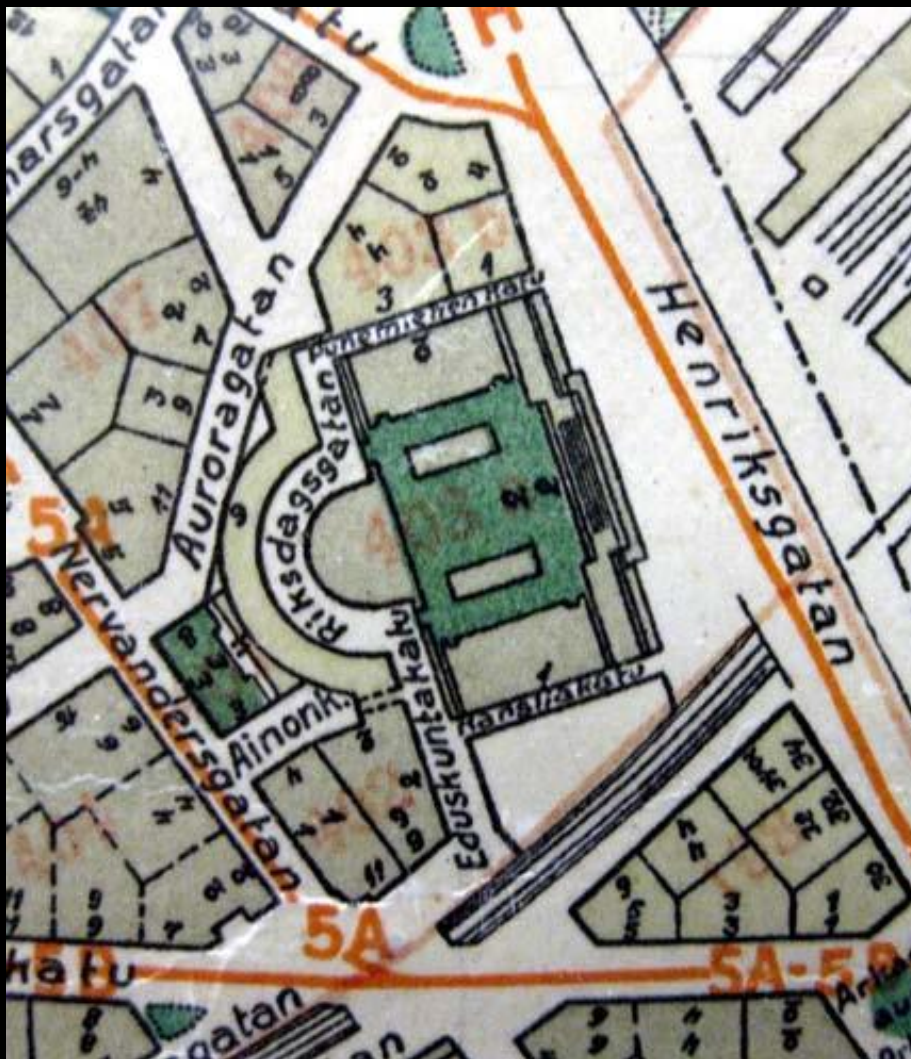

GENERAL PLAN OF THE HILL OF  
ARKADIA, 1920's

THE ARCH SHAPE OF  
CHAIRMAN'S SQUARE IS  
ALREADY THERE  
FOLLOWING THE PROPOSAL OF  
J.S.SIRÉN, ARCHITECT OF THE  
PARLIAMENT HOUSE





CHAIRMAN'S SQUARE IN THE EARLY 1970's



EXCAVATIONS ON THE BUILDING SITE IN 1975





ARCHITECTS  
PULKKINEN-LAIHO-  
RAUNIO 1978

ARCHITECTURAL  
COMPETITION 1970

THE PROPOSAL WAS  
BASED ON THE ARCH  
SHAPE WHICH HAD  
BEEN COMPOSED BY  
J.S.SIRÉN, ARCHITECT  
OF THE PARLIAMENT  
HOUSE



ARCHITECTURAL ARCH  
SHAPE IS VISIBLE  
BOTH EXTERNALLY  
AND INTERNALLY

FACADES MADE OF  
BRASS

ARCHITECTURE IS  
BOTH HUMBLE AND  
NOBLE



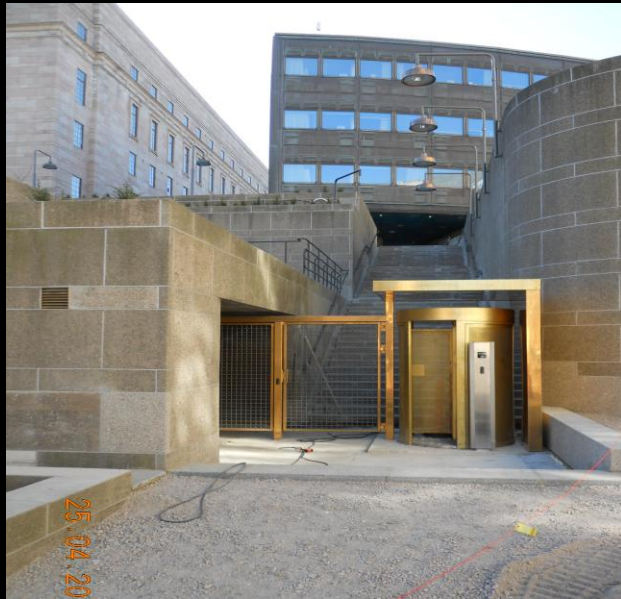

MAIN CONTENT OF THE RENEWAL IN ALL THE  
PARLIAMENT PREMISES :

SERVICE LOGISTICS ARE SITUATED UNDERGROUND

IMPROVING VENTILATION, PIPES, LIGHTING

SECURITY ISSUES

- REINFORCEMENT IN CONTRUCTIONS
- NEW SECURITY GATES IN ALL ENTRANCES





















PORTER STAFF ROOMS ARE REMOVED AND GATHERED DOWNSTAIRS - THE AULAS ON THE UPPER FLOORS SERVE AS COFFEE BREAK ROOMS

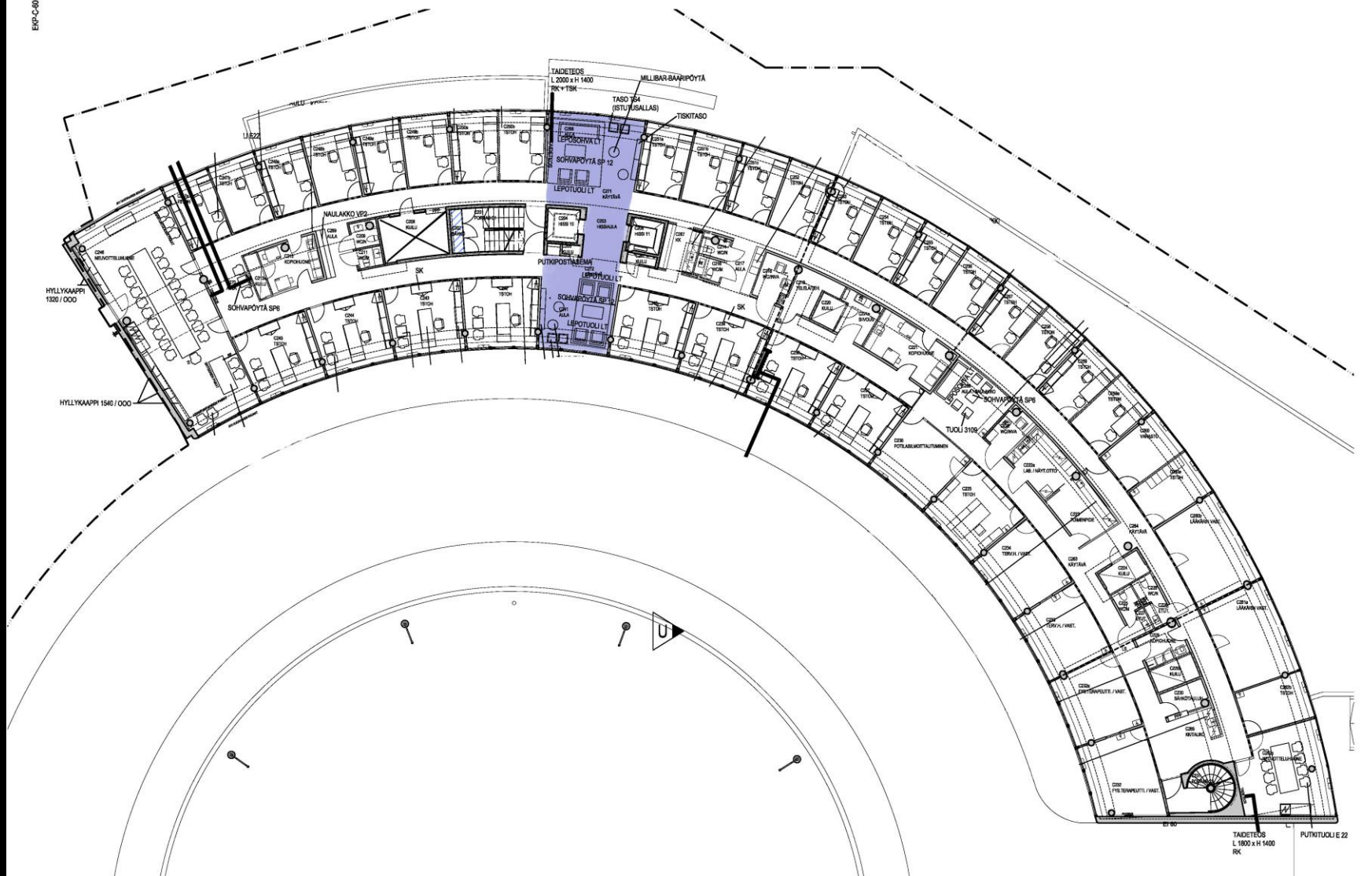

## COFFEE BREAK ROOMS ARE MOVED FROM DARK INNER ROOMS TO DAYLIGHT





## THE WORKING PLACE FURNISHING

- MODERN
- HIGHLY ERGONOMICAL
- ELECTRICALLY ADJUSTABLE TABLE
- GUEST CHAIR RENOVATED ORIGINAL TYPE



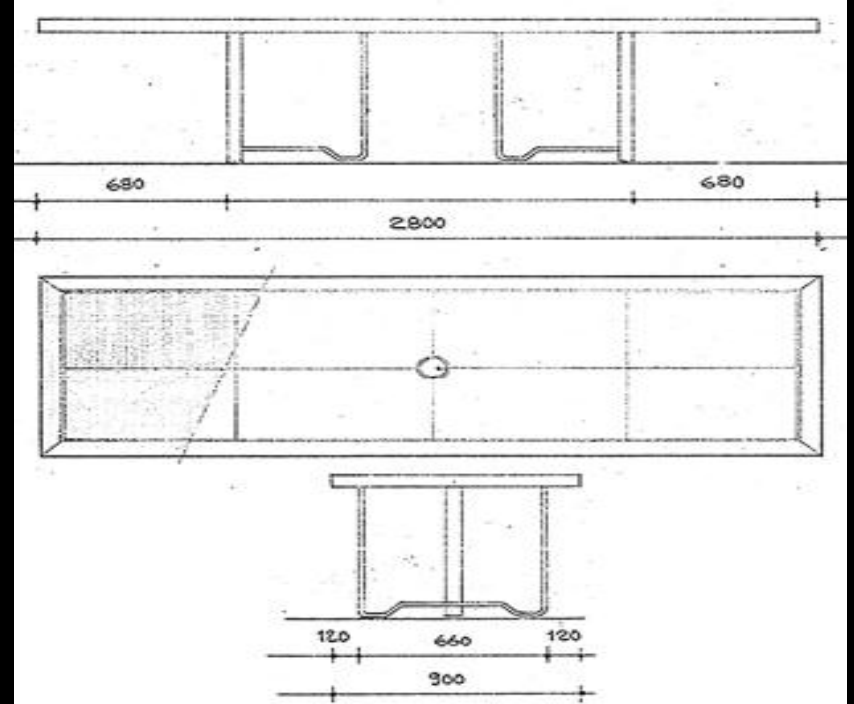
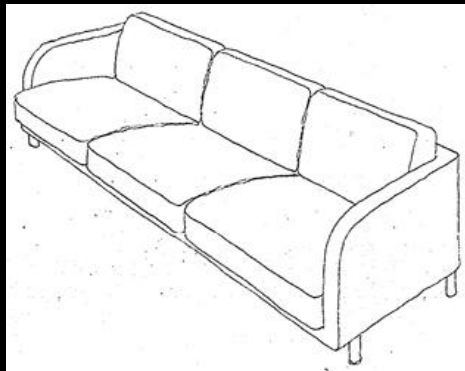
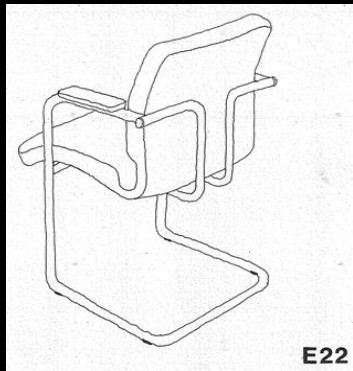
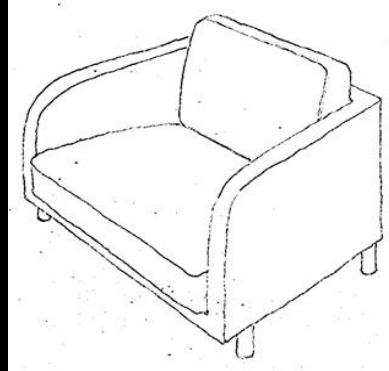

RENOVATED ORIGINAL FURNITURE: CHAIRS, SOFA GROUPS, CONFERENCE ROOM TABLES  
DESIGNED BY ARCHITECTS PITKÄNEN-LAIHO-RAUNIO 1978





READING ROOM BEFORE THE  
RENOVATION, NOVELTIES TO  
COME:

- CONTEMPORARY CHAIRS  
REPLACED WITH RENOVATED  
ORIGINALS
- READING DESKS TECHNICALLY  
MODERNIZED
- A NEW TEXTILE CARPET AS  
ORIGINALLY USED TO BE

